



Colliers d'épaulement cote pouce Sicherungsscheiben Zoll-Standard Anillos de retención pulgadas standard E CLIPS INCH STANDARD

d ₁	N1500 NRA NRF NRG										D A T A			
		s	Δ	d ₃	C ₂	(lbs/1000)	d ₂	Δ	m	Δ	Tc	Tg	Applicator	Dispenser
0.062	NRF006	0.010	±0.001	0.140	0.150	0.028	0.052	+0.002 -0.000	0.012	+0.002 -0.000	36	6	AM2	SF2
0.062	NRA006	0.010		0.156	0.165	0.030	0.052		0.012		36	6	AM3	SF3
0.062	NRG006	0.020		0.187	0.200	0.094	0.052		0.023		72	6	-	-
0.094	NRF009	0.015		0.230	0.245	0.100	0.074		0.018		81	17	AM7	SF4
0.094	NRA009	0.015	±0.002	0.187	0.200	0.058	0.074	+0.002 -0.000	0.018	+0.003 -0.000	81	17	AM5	SF5
0.110	NRF011	0.015		0.375	0.390	0.310	0.079		0.018		95	32	AM6	SF6
0.125	NRA012	0.015		0.230	0.240	0.087	0.095		0.018		108	35	AM7	SF7
0.140	NRF014	0.015		0.203	0.214	0.060	0.102		0.018		121	50	AM8	SF8
0.140	NRG014	0.015		0.250	0.265	0.100	0.110		0.018		121	39	AM10	SF10
0.140	NRA014	0.025		0.270	0.285	0.210	0.105		0.029		202	46	AM9	SF9
0.156	NRA015	0.025	0.282	0.295	0.210	0.116	0.029	225	58	AM11	SF11			
0.172	NRF017	0.025	0.312	0.325	0.240	0.127	0.029	248	72	AM12	SF12			
0.188	NRF018	0.025	0.375	0.390	0.450	0.125	0.029	271	110	AM13	SF13			
0.188	NRA018	0.025	0.335	0.350	0.290	0.147	0.029	271	72	AM14	SF14			
0.219	NRF021	0.025	±0.002	0.437	0.450	0.470	0.188	+0.003 -0.000	0.029	+0.003 -0.000	316	63	AM15	SF15
0.250	NRA025	0.025		0.527	0.540	0.760	0.210		0.029		361	93	AM16	SF16
0.312	NRF031	0.025		0.500	0.520	0.570	0.250		0.029		450	180	AM16	SF17
0.375	NRA037	0.035		0.660	0.680	1.500	0.303		0.039		757	252	AM18	SF18
0.438	NRA043	0.035		0.687	0.710	1.500	0.343		0.039		885	388	AM19	SF19
0.438	NRF043	0.035		0.600	0.620	1.000	0.380		0.039		884	237	AM20	SF20
0.500	NRA050	0.042	0.800	0.820	2.500	0.396	0.046	1210	485	AM21	SF21			
0.625	NRA062	0.042	0.940	0.960	3.200	0.485	0.046	1510	816	AM22	SF22			
0.744	NRF074	0.050	1.000	1.020	4.300	0.625	0.056	2160	1190	AM23	SF23			
0.750	NRA075	0.050	1.120	1.140	5.800	0.580	0.056	2520	1630	AM24	SF24			
0.875	NRA087	0.050	±0.001	1.300	1.320	7.600	0.675	+0.005 -0.000	0.056	+0.004 -0.000	2840	1370	AM25	SF25
0.984	NRF098	0.050		1.500	1.530	9.200	0.835		0.056		4250	1210	AM26	SF26
1.188	NRF188	0.062		1.626	1.670	11.300	1.079		0.068		4920	1860	AM27	SF27
1.375	NRF137	0.062		1.875	1.920	15.400	1.230		0.068		4920	1860	-	-

 **Part Number**
 Référence Teile Nummer Referencia de pieza

 **Tolerance**
 Tolérance Toleranz Tolerancia

 **Weight**
 Masse Gewicht Peso

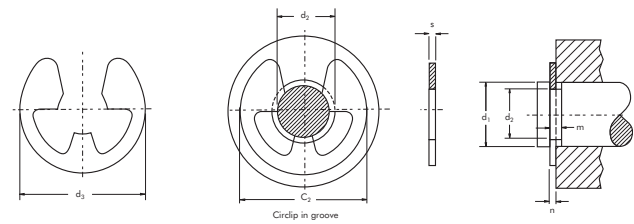

 **Ring**
 Anneau/Circlips Ring Anillo

 **Groove**
 Gorge Nut Ranura



 N1500/NRA/NRF/NRG

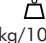

d ₁	9133 NRL												D A T A				
		s	Δ	d ₃	Δ	d ₄	C ₂	 (kg/1000)	d ₂	Δ	m	min					
2	NRL2	0.25	+0.00 -0.03	1.51		4.70	4.75	0.02	1.56	+0.05 -0.00	0.30						
2.5	NRL2.5	0.40		1.99		5.30	5.37	0.04	2.06		0.45						
3	NRL3	0.40		2.23		6.00	6.07	0.05	2.30		0.45						
4	NRL4	0.60		2.89		7.15	7.37	0.10	3.10		0.67						
4.5	NRL4.5	0.60		3.50		8.00	8.10	0.13	3.60		0.67						
5	NRL5	0.60		3.68		8.50	8.62	0.14	3.80		0.67						
6	NRL6	0.60		4.70		11.10	11.19	0.18	4.80		0.67						
7	NRL7	0.60		5.25		13.40	13.54	0.20	5.40		0.67						
8	NRL8	0.60		6.17		12.70	12.93	0.24	6.40		0.67						
9	NRL9	0.80		6.85		13.80	13.95	0.39	7.00		0.90						
10	NRL10	0.80	+0.00 -0.05	7.85		15.00	15.15	0.45	8.00		0.90						
11	NRL11	0.80		8.45		16.40	16.55	0.56	8.60		0.90						
12	NRL12	0.80		9.45		17.70	17.85	0.58	9.60		0.90						
13	NRL13	1.00		10.10		19.00	20.61	0.82	10.24		1.10						
14	NRL14	1.00		11.10		20.40	20.54	0.95	11.24		1.10						
15	NRL15	1.00	+0.07 -0.00	11.90		21.60	21.74	1.04	12.04		1.10						
16	NRL16	1.00		12.90		23.00	23.14	1.11	13.04		1.10						
17	NRL17	1.00		13.65		24.30	24.49	1.29	13.84		1.10						
18	NRL18	1.00		14.65		25.60	25.79	1.47	14.84		1.10						
19	NRL19	1.20		15.51		26.80	26.99	1.76	15.70		1.35						
20	NRL20	1.20	+0.00 -0.06	16.48		28.20	28.42	2.12	16.70		1.35						
22	NRL22	1.20		18.32		30.80	31.02	2.30	18.54		1.35						
25	NRL25	1.20		21.10		34.80	38.63	2.71	21.40		1.35						
30	NRL30	1.50		25.85		41.20	41.55		26.20		1.65						
35	NRL35	1.50		30.60		47.60	47.81		31.00		1.65						

 **Part Number**
Référence Teile Nummer Referencia de pieza

 **Tolerance**
Tolérance Toleranz Tolerancia

 **Weight**
Masse Gewicht Peso

 **Ring**
Anneau/Circlips Ring Anillo

 **Groove**
Gorge Nut Ranura

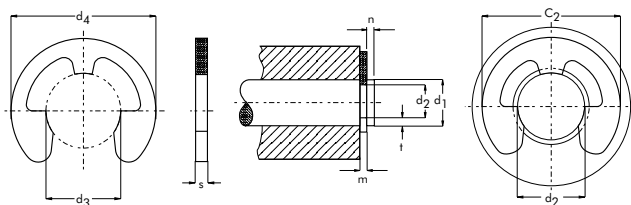

9133/NRL



CIRTEQ