



| d ₁ | Δ | KS |  | | | | | | D A T A | |
|----------------|------------------|--------|---|----------------|------|---|--------|-----|--|-------|
| | | | d ₃ | d ₄ | s |  | n min. | h ≈ |  (kg/1000) | H (N) |
| 1.5 | +0.000 -0.025 | KS1.5 | 1.30 | 6.00 | 0.25 | 3 | 2.5 | 1.2 | 0.10 | 200 |
| 2.0 | | KS2.0 | 1.80 | 7.00 | 0.30 | 3 | 2.5 | 1.3 | 0.13 | 400 |
| 2.5 | | KS2.5 | 2.30 | 8.25 | 0.30 | 3 | 2.5 | 1.5 | 0.15 | 700 |
| 3.0 | | KS3.0 | 2.80 | 10.00 | 0.40 | 3 | 3.0 | 2.0 | 0.20 | 1200 |
| 3.5 | +0.000 -0.030 | KS3.5 | 3.25 | 11.50 | 0.40 | 3 | 3.0 | 2.0 | 0.25 | 1200 |
| 4.0 | | KS4.0 | 3.75 | 13.00 | 0.50 | 4 | 3.5 | 2.4 | 0.50 | 1300 |
| 5.0 | | KS5.0 | 4.75 | 15.00 | 0.50 | 4 | 3.5 | 2.7 | 0.75 | 1500 |
| 6.0 | | KS6.0 | 5.75 | 16.50 | 0.60 | 6 | 4.0 | 2.6 | 1.15 | 1800 |
| 7.0 | +0.000 -0.036 | KS7.0 | 6.75 | 18.00 | 0.60 | 6 | 4.0 | 2.9 | 1.25 | 2000 |
| 8.0 | | KS8.0 | 7.75 | 19.50 | 0.70 | 6 | 4.0 | 2.8 | 1.40 | 3000 |
| 9.0 | | KS9.0 | 8.75 | 21.00 | 0.70 | 6 | 4.0 | 3.0 | 1.50 | 3500 |
| 10.0 | | KS10.0 | 9.75 | 22.00 | 0.80 | 6 | 4.0 | 3.0 | 1.65 | 4000 |

 **Part Number**
Référéce Teile Nummer Referencia de pieza

 **Tolerance**
Tolérance Toleranz Tolerancia

 **Weight**
Masse Gewicht Peso

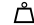
 **Ring**
Anneau/Circlips Ring Anillo

 **Groove**
Gorge Nut Ranura

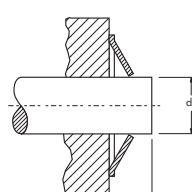
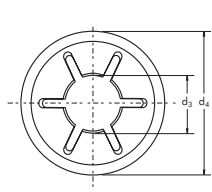

KS

CIRTEQ